

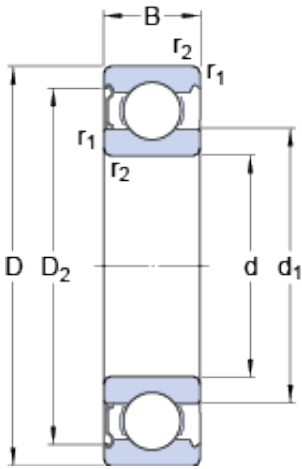

NEI Manufacturing India Private LTD.



25 mm x 52 mm x 15 mm SKF 6205-Z deep groove ball bearings

Bearing No. 6205-Z

6205-Z Bearing 2D drawings and 3D CAD models

Size	52x25x15 mm
Bore Diameter	52 mm
Outer Diameter	25 mm
Width	15 mm
d	25 mm
D	52 mm
B	15 mm
d ₁	34.35 mm
D ₂	46.21 mm
r _{1,2} - min.	1 mm
d _a - min.	30.6 mm
d _a - max.	34.3 mm
D _a - max.	46.4 mm
r _a - max.	1 mm
Basic dynamic load rating - C	14.8 kN
Basic static load rating - C ₀	7.8 kN
Fatigue load limit - P _u	0.335 kN
Reference speed	28000 r/min
Limiting speed	18000 r/min
Calculation factor - k _r	0.025
Calculation factor - f ₀	14
Category	Single Row Ball Bearings
Inventory	0.0
Manufacturer Name	SKF



NEI Manufacturing India Private LTD.

Minimum Buy Quantity	N/A
Weight / Kilogram	0.13
EAN	7316577067791
Product Group	B00308
Enclosure	1 Metal Shield
Precision Class	ABEC 1 ISO P0
Maximum Capacity / Filling Slot	No
Rolling Element	Ball Bearing
Snap Ring	No
Internal Special Features	No
Cage Material	Steel
Internal Clearance	C0-Medium
Inch - Metric	Metric
Long Description	25MM Bore; 52MM Outside Diameter; 15MM Outer Race Diameter; 1 Metal Shield; Ball Bearing; ABEC 1 ISO P0; No Filling Slot; No Snap Ring; No Internal Special Features
Category	Single Row Ball Bearing
UNSPSC	31171504
Harmonized Tariff Code	8482.10.50.68
Noun	Bearing
Keyword String	Ball
Manufacturer URL	http://www.skf.com
Manufacturer Item Number	6205-Z
Weight / LBS	0.29
Outside Diameter	2.047 Inch 52 Millimeter
Outer Race Width	0.591 Inch 15 Millimeter
Bore	0.984 Inch 25 Millimeter
d ₁	34.35 mm
D ₂	46.21 mm



NEI Manufacturing India Private LTD.

d_a min.	30.6 mm
d_a max.	34.3 mm
D_a max.	46.4 mm
r_a max.	1 mm
Basic dynamic load rating C	14.8 kN
Basic static load rating C_0	7.8 kN
Fatigue load limit P_u	0.335 kN
Calculation factor k_r	0.025
Calculation factor f_0	14
Mass bearing	0.13 kg